

Based on Ordnance Survey Ireland data and reproduced under Ordnance Survey Ireland Licence Number "2016/26/CMA/Kildare County Council". Unauthorised reproduction infringes Ordnance Survey Ireland and Government of Ireland copyright.

- KEY:
- Proposed Permanent CPO Boundary
  - New Verge Provision
  - New Footpath/Cycleway (Shared Use)
  - New Uncontrolled Crossing
  - Extent of Existing Road Used for Future Footpath/Cycleway
  - Indicative Extents of Low Level screening on verge (0.6m height)

NOTES:

- Uncontrolled crossing specification follows the NRA DMRB DN-GEO-03033: Geometric Design of Roundabouts (2009) and NRA Pedestrian Crossing Specification and Guidance (2011).
- Pathway from existing footbridge to crossing at southern roundabout to be widened to 2.2m, matching the width of the existing footbridge.
- 'Cyclists Dismount' signage to be placed at both ends of footbridge due to low bridge parapet height.
- Extend new cycle/pedestrian facility to new uncontrolled crossing north of existing footbridge.
- Cycle/pedestrian facility design per National Cycle Manual and Design Manual for Urban Roads and Streets - TBC.
- Bollards to match the style and placement observed on other nearby cycle/pedestrian routes, including the frontage roads parallel to the N7 to the east of Junction 8.
- Lighting and drainage requirements to be developed through detailed design.
- Cycleway and path width (shared use) to be 4m. At location of restricted width this is reduced to 3.8m (over approximate 1m length).
- Earthworks shown as indicative. To be confirmed in detailed design.
- Extents of existing carriageway to be utilised for provision of shared use path and cycleway as far as practicable with surface condition adjusted as necessary.
- Design incorporates mitigation proposed in the Stage 1 Road Safety Audit.

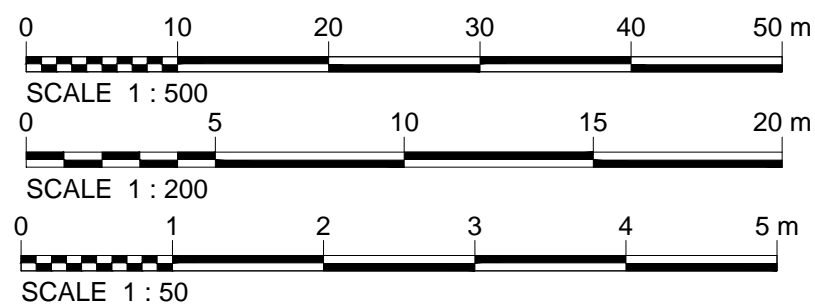

3	07/08/2017	EIAR SUBMISSION	AR	CD	CD	RR
2	30/06/2017	EIAR SUBMISSION	KMA	CD	CD	RR
1	22/06/2017	UPDATE FOLLOWING STAGE 1 SAFETY AUDIT	AR	DM	CD	RR
0	16/03/2017	DRAFT EIS SUBMISSION	AR	DM	CD	RR
Rev	Rev. Date	Purpose of revision	Drawn	Checked	Rev'd	Approved

**JACOBS**

Jacobs, Merrion House, Merrion Road, Dublin 4  
Tel: +353 (1) 269 5666  
www.jacobs.com



Project  
**KERRIFFSTOWN LANDFILL  
REMEDATION PROJECT**

Drawing title  
**FIGURE 4.11  
NEW SITE ACCESS PROPOSED  
PEDESTRIAN ACCESS AND CYCLEWAY  
FOR THE PROPOSED PROJECT**

Drawing status  
**EIAR SUBMISSION**

Scale	AS SHOWN @A1	DETAILS SHOWN ARE NOT FOR CONSTRUCTION PURPOSES HENCE DRAWING SHOULD NOT BE SCALED
Jacobs No.	32EW5604	
Client no.	6286	

Drawing number <b>32EW5604-00-030</b>	Rev <b>3</b>
--	-----------------

This drawing is not to be used in whole or part other than for the intended purpose and project as defined on this drawing. Refer to the contract for full terms and conditions.

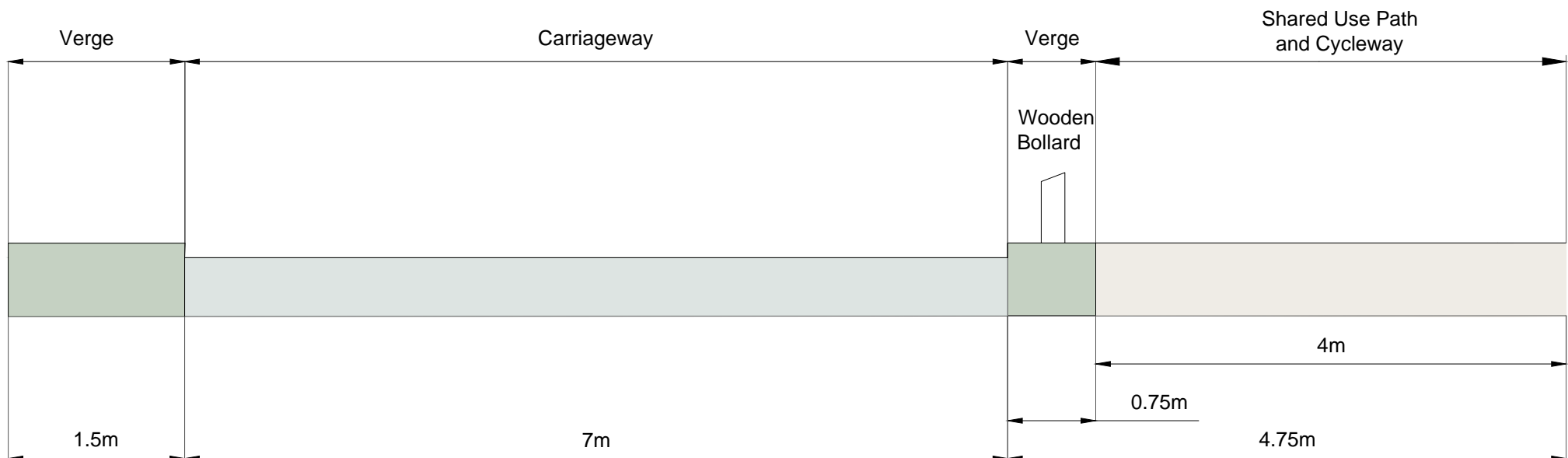
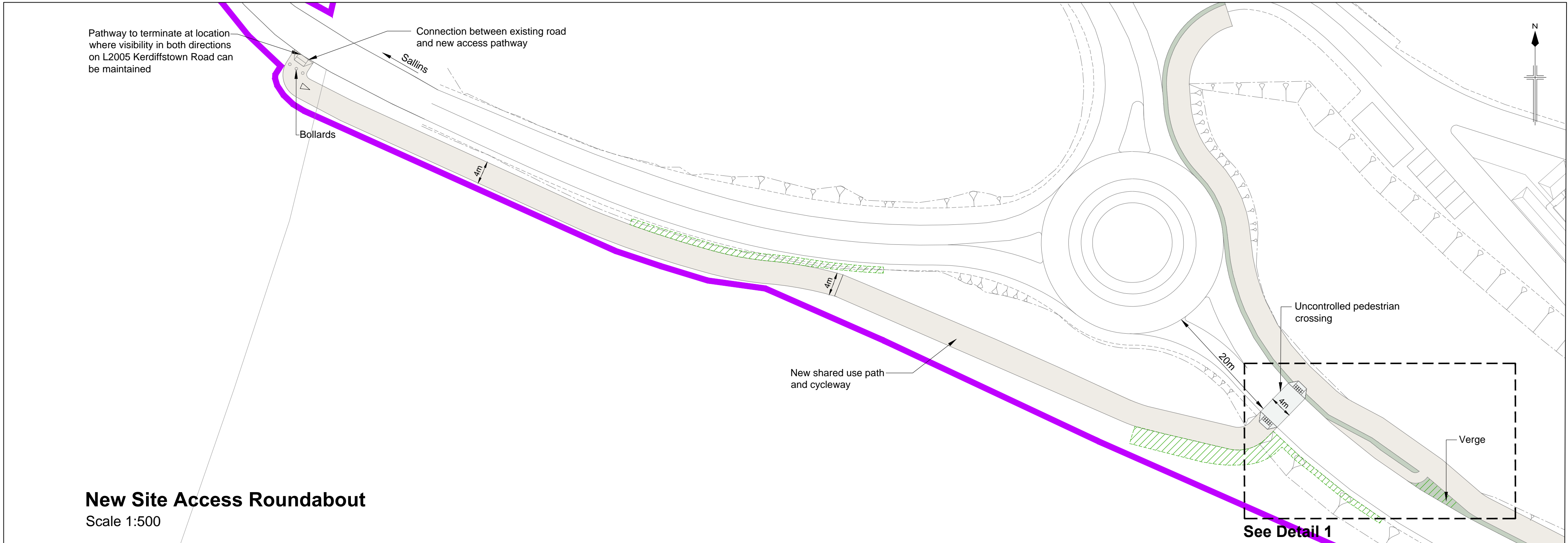

Example of Verge and Wooden Bollards



Example of Uncontrolled Crossing at Naas

