

W0248-a

Sub 116

DRUM BO,
CAVAN.
3.4.2009

SUBMISSION

RE: APPLICATION TO EXTEND THE AREA BEING LICENCED AT CORANURE LANDFILL

Dear Sir,

The above existing site has over the years been grossly mismanaged, litter is blowing all over my lands: Odour is continually stomach-churning: Birds have completely taken over the area leaving it impossible for human habitation: Damage to the landscape in a visual sense is unacceptable and the density of traffic going to and fro carrying rubbish with pieces falling off and scattering over the road. In particular the area adjacent to my land is causing storm water to join with leachate and flood onto my land due to drains being closed and inadequate gipses replacing them. A map of my land where the leachate is building up is enclosed, (area highlighted in green) this leachate is permeating into the water table.

If this is acceptable to the K.P.A. your position on the matter is untenable.

Yours sincerely

Edmund Mc Cabe
EDMUND MC CABE

Consent of copyright owner required for any other use.
ENVIRONMENTAL PROTECTION AGENCY
07 APR 2009

THE LICENSOR,
K.P.A.
JOHNSTOWN CASTLE,
WEXFORD.

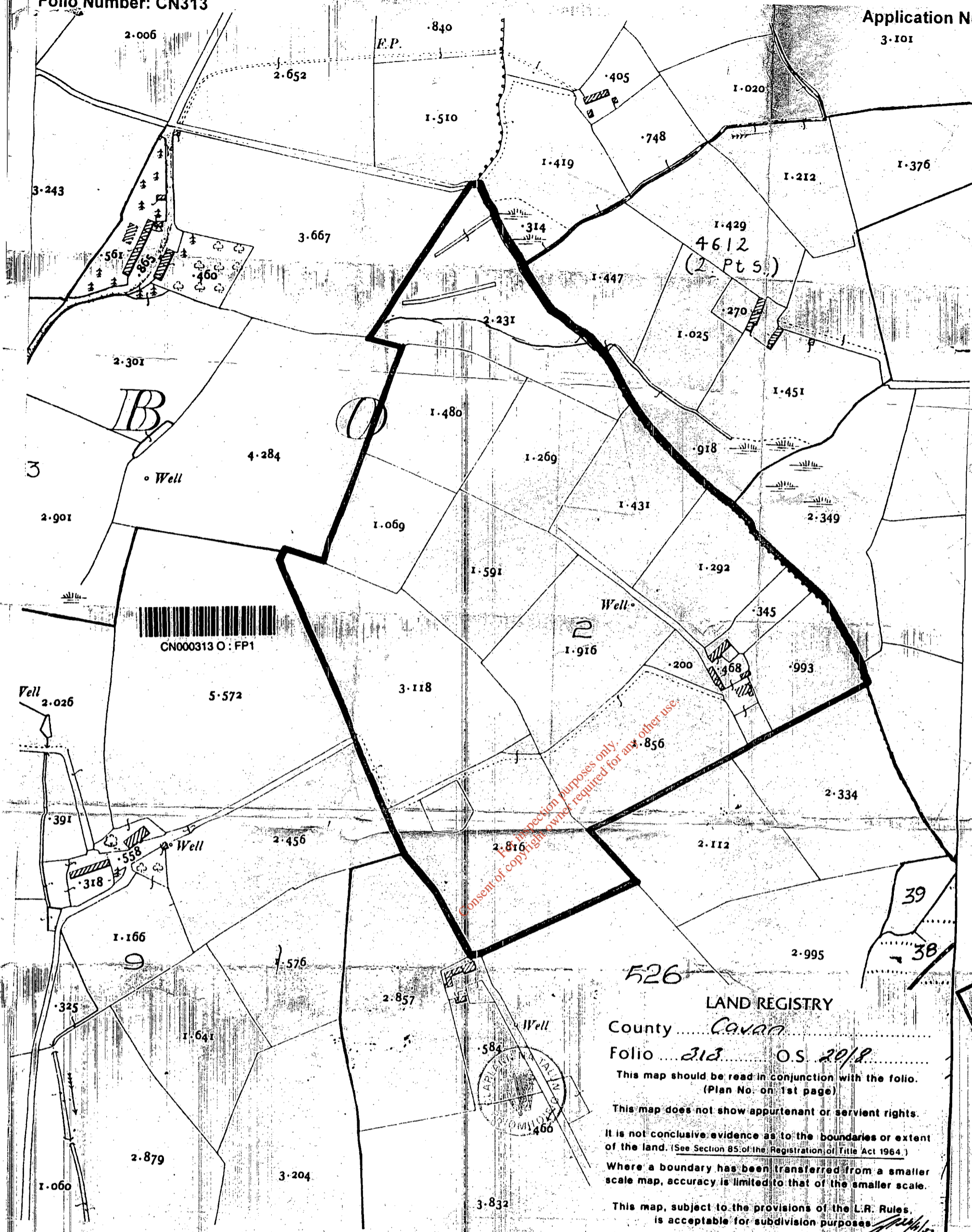

Consent of copyright owner required for any other use.

LAND REGISTRY
 County *Cavan*
 Folio *313* O.S. *2018*
 This map should be read in conjunction with the folio.
 (Plan No. on 1st page)
 This map does not show appurtenant or servient rights.
 It is not conclusive evidence as to the boundaries or extent
 of the land. (See Section 85 of the Registration of Title Act 1964.)
 Where a boundary has been transferred from a smaller
 scale map, accuracy is limited to that of the smaller scale.
 This map, subject to the provisions of the L.R. Rules,
 is acceptable for subdivision purposes.

ENVIRONMENTAL PROTECTION
 AGENCY
 07 APR 2008